

Technical drawing of a 3-way valve assembly. The drawing shows a central valve body with three ports. The top port is labeled "SW 16". The bottom port is labeled "6-kt.13" and has a thread specification of "G1/8". The side ports are labeled "301..". Dimensions are provided for the overall size and port spacing:

- Overall width: $\text{ca. } 51,2$
- Distance between side ports: $2 \times \text{ca. } 25,6$
- Distance between side ports (inner): $2 \times \text{ca. } 18,6$
- Overall height: $29,4$
- Distance from top to side port center: $21,4$
- Distance from bottom to side port center: 7
- Bottom port diameter: $\phi 14,2$
- Side port diameter: $2 \times \phi 14,5$
- Note: $2 \times \text{für Schlauch mit Außen-}\phi 8_{\pm 0,15}$

All rights to these drawings belong exclusively to the company Eisele Pneumatics GmbH & Co. KG. The reproduction and / or dissemination and other abuse without our prior, explicit consent are inadmissible. Those who do not follow these directions are obliged to pay damages and are punishable by law.

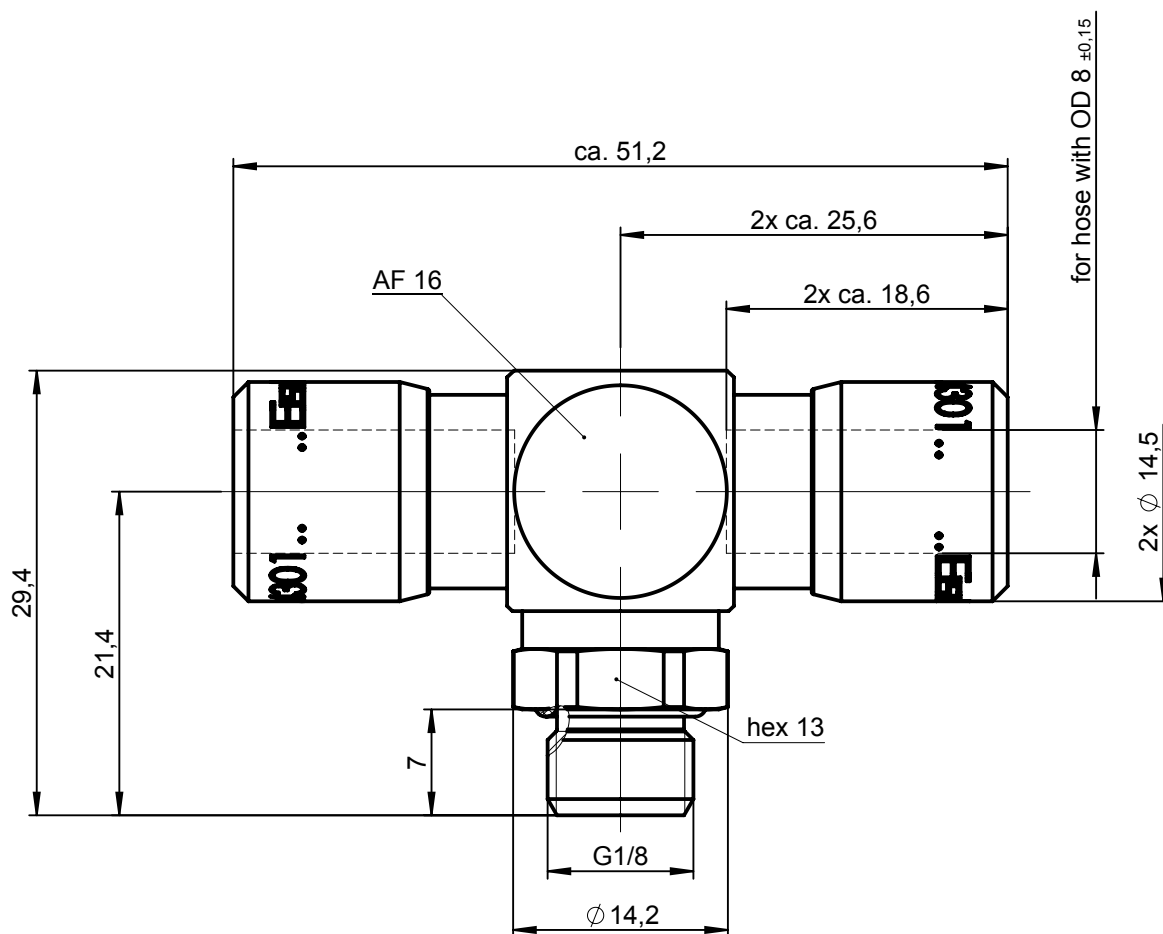

ND6

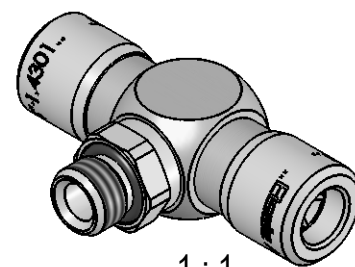

1:1

Material:stainless Steel 1.4301
Seals FKM

			Standard Tolerances DIN ISO 2768-mH-E		Dimension Sheet		Weight ca. 49 g
Status: FREIGABE EINFACH			Date	Name	Title		Scale
Revision (Index):			Drawn 11.12.15	Mü	T screw-in connector swiveling		2:1
0			Appr. 11.12.15	Ha	Part-No. 988-0206		ISO E
			Client		Drawing-No. 988-0206-00		
Date	modified	verified			in exchange for Date	replaced with Date	Blatt 2 von 2
					Revision	Revision	